

Saflok[™]
A Member of the Kaba Group



Their Security.
Your Control.

SAM RF[®] & InSync[®]

The latest design in multi-family security provides a wireless convenience that is second to none. SAM RF[®] driving the InSync[®] lock series puts property managers in the driver's seat of access solutions and key control while ensuring residents' upgraded safety.

The key credential communicates with the lock via radio frequency (RF) waves. A complete system includes: the SAM RF[®] software, the key encoder, and the RFID key.

SAM RF[®] Software

Easy-to-Use Software

SAM RF[®] is a Windows-based program that offers point-and-click functionality for fast and easy key making, database management report creation, and work order processing. Several strokes of the keyboard complete the key programming process. SAM RF has the ability to interface with existing property management systems.

Single or Multiple Properties: Flexible Solutions

SAM RF offers the ability to control multiple properties from a single database thus centralizing your key control and key making operation. Additionally, SAM RF allows you to add multiple SAM RF property databases to a single server networking throughout your communities. This application allows site level key control as well as overall administrative control at a centralized location.

Multiple Reports

SAM RF users can request a variety of building management reports including an extensive transaction history report. Other reports include unit key history, key user history, keys made, limited use audits, and lock audits.

RF Key Encoder

Dual Function RF Key Encoder

The RF key encoder is a station that includes a utility device and an encoder. The RFID key is placed into the docking station on the encoder each time it needs to be programmed. The utility device is a detachable handheld unit that is used for programming and auditing the locks.





RFID Key

With this new system, an encrypted code is programmed into the RFID key making it a unique communication credential. This credential carries information to the lock "instructing" it to either allow or deny access. Each exchange of information between lock and RFID key is stored, and it is available for audit inside the lock.

Rugged Durability

As information is relayed via RF waves, the RFID key communicates with the lock when inserted into the lock's key port. The RFID key does not require physical electrical contact points to connect to the lock. Instead, it gets its power and communications through proximity, giving it a tremendous advantage over metallic conductors that need protection from the corrosive elements and the physical frictional wear of repeated use.

The RFID key is made of a special polymer that is impervious to moisture. It can be inserted into the key port in any direction to activate the lock.

Single-Key Convenience

The RFID key is ideal for use in residential communities, especially those that offer a variety of amenities. One RFID key can operate private residence locks as well as multiple common access area locks of management's choosing.

Wireless Wonder

RFID keys work continuously, or expire at specifically programmed times or when cancelled by the operating system. An expiration date is programmed on each key when it is made. A RFID key can be reprogrammed as many times as necessary and will automatically cancel out the previous RFID (in the event it is lost or stolen) without reprogramming the lock.



SAM RF® encoder and utility device allow for uninterrupted and concurrent use of both devices for different functions. A RFID key can be programmed while an audit trail report is being downloaded from a lock.

SAFLOK's InSync® lock series is a complete line of locks for every residential and community living application. InSync locks are stand-alone battery operated locks. Unit locks and suite locks are able to store an audit trail of up to 200 entries. Since common access locks are designed for use in heavy traffic areas, these locks store 2000 entries.

1. Apartment Entry Door (D, I, L, M)
2. Bedroom Doors (D, I, L, M)
3. Patio Storage Closet (D, I, L, M)
4. Community Room (C, L, M)
5. Pool Gate (C, L, M)
6. Pedestrian Gate (C, L, M)
7. Roll-up Garage Door (CR)
8. Parking Arm (CR)
9. Elevator (CR)
10. Business Center (L, C, M)
11. Exercise Room (C, L, M)
12. Store Room (D, I, L, M)
13. Mechanical Room (D, I, L, M)
14. Office Door (D, I, L, M)
15. Stairwell Door (C, L, M)
16. Entrance Door (CR, C, L, M)
17. Leasing Office (CR, D, I, L, M)

Depending upon the door types and building codes, a variety of the InSync CR products may be applicable.

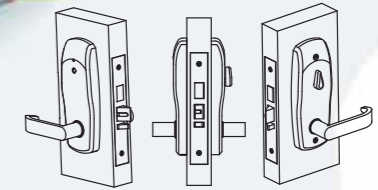
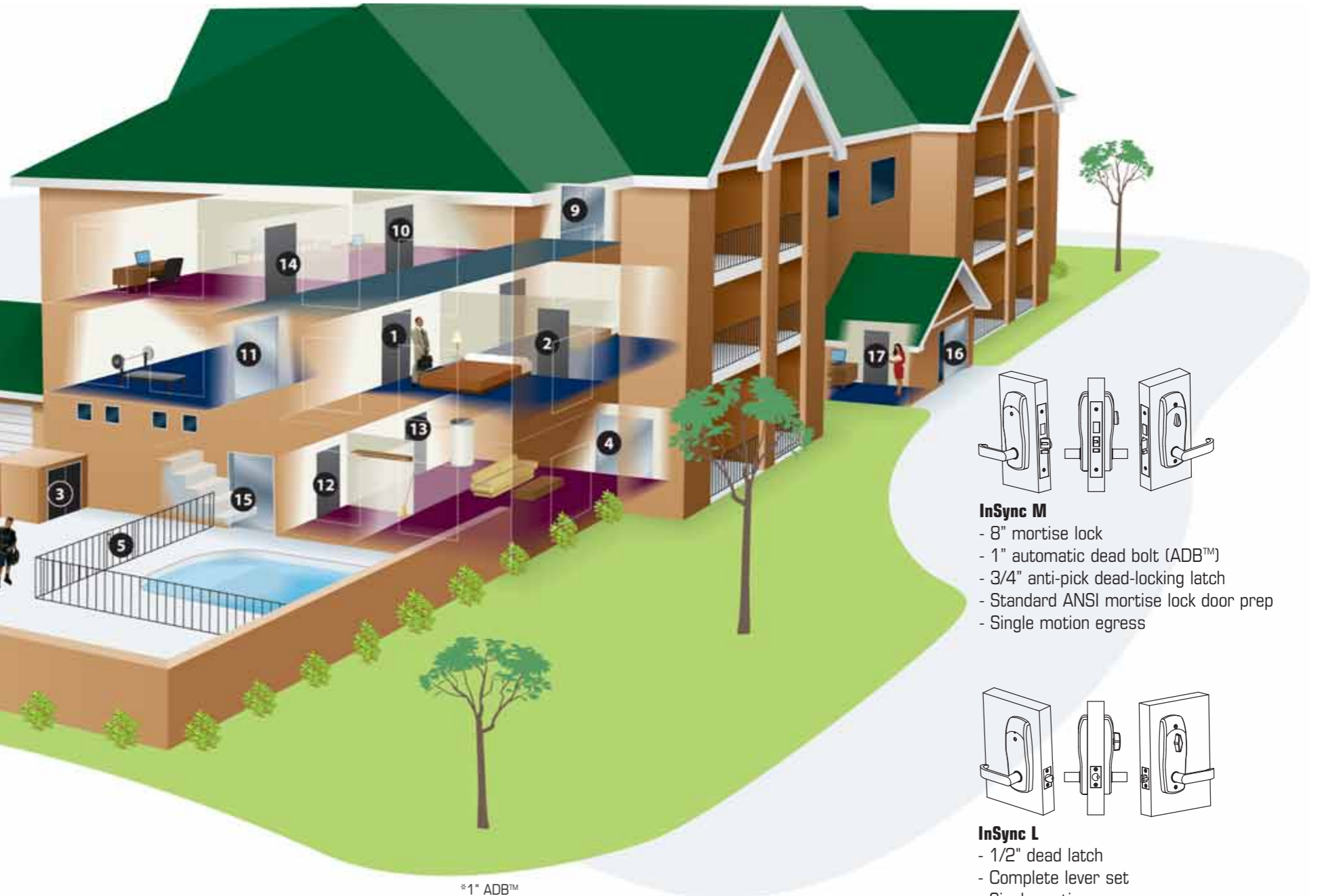

- InSync M**
- 8" mortise lock
 - 1" automatic dead bolt (ADB™)
 - 3/4" anti-pick dead-locking latch
 - Standard ANSI mortise lock door prep
 - Single motion egress

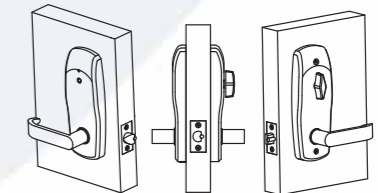

- InSync L**
- 1/2" dead latch
 - Complete lever set
 - Single motion egress
 - Interior thumb-turn

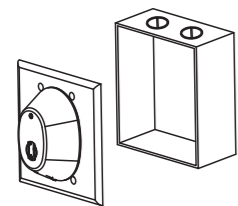

- InSync CR**
- Remote control unit includes a stand-alone reader that works with any electronic latching device

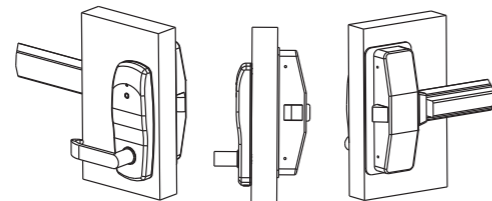

- InSync CP**
- Works in conjunction with rim or vertical exit hardware for common/community area doors

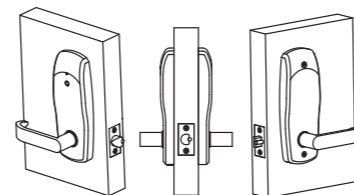

- InSync CL**
- 1/2" dead latch
 - Single motion egress with common area electronics

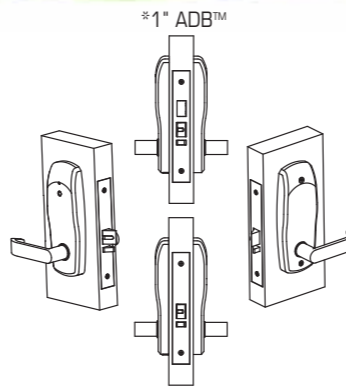

- InSync CM**
- *Optional 1" automatic dead bolt (ADB®)
 - 3/4" anti-pick latch
 - Single motion egress with common area electronics

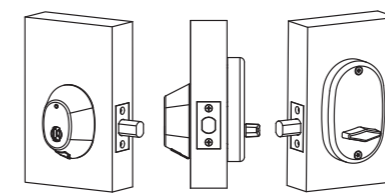

- InSync D**
- 1" dead bolt
 - Interior thumb-turn
 - Standard dead bolt door prep

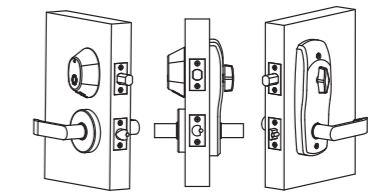

- InSync I**
- Full 1" dead bolt
 - Complete interconnected lever set
 - Single motion egress
 - Interior thumb-turn

The New Age of Key Control

SAM RF® and InSync® are powerful solutions that increase flexibility, security, and efficiency in your daily operations.

Employee activity is documented via lock access points. As each RFID key has a specific identity code, simply download lock audit information to identify which RFID key has been used. The ability to track RFID key usage and to interrogate locks greatly reduces theft, vandalism, and associated losses.

For maintenance personnel, a single RFID key replaces a heavy ring of keys. If a master RFID key is lost, a new one can be made in just a few simple strokes of the keyboard. The new RFID key automatically cancels out the old RFID key when it is inserted into the lock. This shaves hours off labor and significantly reduces the risk of liability.

InSync D is ideal for retrofitting.

SAFLOK puts you InSync with the future of residential building management — ***Their Security. Your Control.***



FINISH		Apogee™	Arc	Troy**	Gala	Continental	Vintage	Regal Knob
	Bright Chrome 625	•*	•*	•*	•*	•*	•*	
	Bright Brass 605	•*	•*	•*	•*	•*	•*	•*
	Satin Chrome 626	•	•	•	•	•	•	
	Satin Brass 606	•	•	•	•	•	•*	•*
	Satin Nickel 619	•	•	•	•			
	Dark Mahogany 690		•	•	•	•	•	•*
	Satin Stainless 630							•*
	Bright Stainless 629							•*

- Apogee™ levers are EHC™ (PVD) coated and available at an up-charge of \$10 per lock.
- * Contact SAFLOK for availability. Demand for various finishes in these styles is sporadic, and they may need to be shipped from overseas. Standard lead time is 14 weeks (shipping by ocean) and 8-10 weeks (airfreight lead time with a \$5 per lock up-charge). Lead times can be verified upon request. Be sure that your quote notes indicate airfreight so that we can bill accordingly.
- ** Troy lever is not available with the InSync I lock.



For worldwide office locations and contact information, visit us at www.saflok.com.

USA·Canada
Phone: **877.272.3565**

Europe · Middle East · Africa
Phone: **33.1.30.13.04.04**

Asia
Phone: **86.10.5861.3561**



Manufactured under one or more of the following patents:
 U.S.: 4,177,657; 4,411,144; 4,534,194; 4,890,870; 5,198,643;
 5,477,041; 5,820,177; 5,986,564; 7,051,561; D494,841; D501,131
 D512,899; D519,021; D531,629; D533,009; D533,047; D533,762;
 D533,763; D535,629 CANADA: 1,252,854; 1,298,902
 U.K. 2,010,375
 Other U.S. and foreign patents pending

SAFLOK reserves the right to modify the characteristics and features of all products in this publication.
 ©2008 SAFLOK, all rights reserved.